



NOTICE OF PUBLIC HEARING CITY OF WESTLAKE

NOTICE IS HEREBY GIVEN that on **Monday, January 23, 2017 at 7:00 p.m.** the City Council of the City of Westlake will hold a Special Council Meeting at the Westlake Council Chambers located at 4005 Seminole-Pratt Whitney Road, Westlake, Florida, 33470 to consider the following public hearing application:

Applicant: Minto PBLH, LLC

Project Name: Minto Westlake, Pod C-1, Traditional Town Development, Final Plat

Location: : East of Seminole Pratt Whitney Road, South of 60th Street North, and North of Town Center Parkway.

SIZE OF PROPERTY: 6.19 acres

REQUEST: The applicant, Minto PBLH, LLC., is requesting approval of the proposed Final Plat for Minto Westlake, Pod C-1, Traditional Town Development.

LEGAL DESCRIPTION: Parcel of land lying in Section 1, Township 43 South, Range 40 East, in the City of Westlake, Palm Beach County, Florida.

LOCATION MAP:

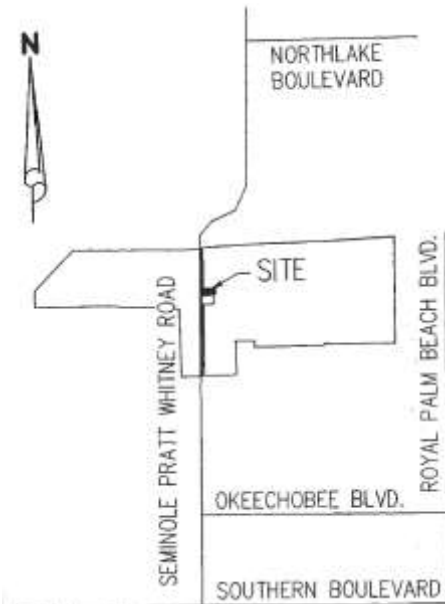

Information relating the subject application is on file and may be examined at the City of Westlake, 4001 Seminole-Pratt Whitney Road, Westlake, Florida, 33470. All persons are invited to appear at this meeting or be represented by an agent, or to express their views in writing addressed to the City Clerk, 4001 Seminole-Pratt Whitney Road, Westlake, Florida, 33470. Maps and other data pertaining to these applications are available for public inspection during normal business hours at the City Offices. Any

persons wishing to speak at the public hearing should register with the City Clerk prior to that item being heard. Inquiries regarding the item may be directed to the City of Westlake at 561-530-5880.

Pursuant to Section 286.0105, Florida Statutes, if a person decides to appeal any decisions made by the City Council with respect to any matter considered at such meeting or hearing, they will need to ensure that a verbatim record of the proceedings is made, which record includes the testimony and evidence upon which the appeal is to be based. This notice does not constitute consent by the City for introduction or admission of otherwise inadmissible or irrelevant evidence, nor does it authorize challenges or appeals not otherwise allowed by law.

In accordance with the Americans with Disabilities Act, all persons who are disabled and who need special accommodations to participate in this meeting because of that disability should contact the City Clerk at 954-753-5841, extension 40532, no later than 48 hours prior to the proceeding. If you are hearing or speech impaired, please contact the Florida Relay Service at (800) 955-8770 for aid in contacting the City.